

The most common issue upon vaping occurs when a cartridge or battery is over-tightened which can cause the positive pin (metal centerpiece) to recess inside the 510 connector.

Estimated Time:
2-5 Minutes

Difficulty Level:
Easy

Tools Needed:

1 x Paper clip or Push Pin or Toothpick



Instructions:

Step One: Untwist the cartridge from the battery and inspect the centerpiece of the battery device and cartridge (Fig. A)

Step Two: Use a small tool to gently pry the pin of the cartridge or battery outwards (Fig. B)

Note: Be careful not to pry the positive pin too far up, as this will, remove it from the battery device. Lift the pin evenly by a small amount.

Step Three: Ensure the positive pin is in a higher position than before (Fig. B)

Step Four: Connect the battery and cartridge by lightly twisting together, ensuring not to over tighten them

Conclusion: Most of the time this will solve the problem, assuming your battery is charged and your cartridge has oil in it

For further assistance, please contact our Support Team: Monday - Friday 9:30am - 5:00pm

www.kurvana.com | hello@kurvana.com
(888) 588-5873

Cartridge

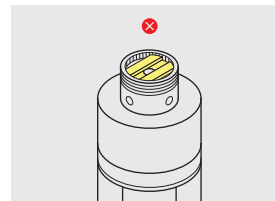

Fig. A

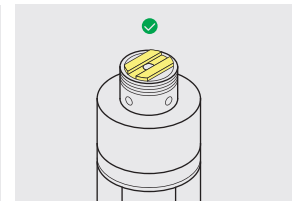

Fig. B

Battery

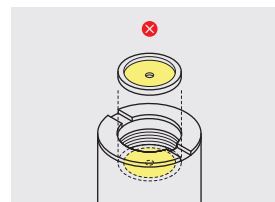

Fig. A

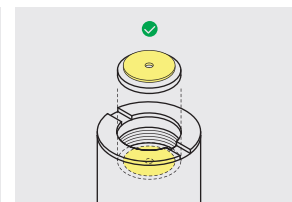

Fig. B

Assembly

